

## AruAL 78 Cora IN

### Inward opening tilt-and-turn wooden-aluminium window

- Made to Measure Sizes
- Good thermal performance—Window Uw 0.85 W/m<sup>2</sup>K of window 1230x1480 mm, glass Ug-0,56
- Frame thickness 78 mm + aluminium cover
- Sash profile thickness 78 mm + aluminium cover
- Timber selection:
  - fingerjointed or selected laminated pine timber;
  - laminated oak timber
- Timber finishing with waterbased paint or stain. Paint according to RAL color chart, stane according to manufacturer's samples.
- Aluminium cladding - powder coated. Paint according to RAL color chart
- Triple glazing, thickness 42 mm (Ug>0,56)
- Glazing with glazing beads inside, sealing from inside and outside with silicone
- Glazing bar options:
  1. penetrating glazing bars
  2. Vienna glazing bars (Norwegian style)
  3. glued-on decorative bars (Georgian style)
  4. decorative bars inside the glass unit

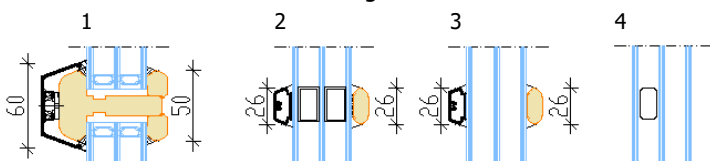

- Extras:
  - special glasses (toughened, laminated, sun protection, self cleaning, pattern, etc.), different materials and different colors of edge mouldings;
  - tilt first opening (TF), safety fittings
  - lockable handles, design handles;
  - insect nets;
  - jamb extensions, window boards;
  - trickle vents
- Various combinations with opening and non-opening parts
- Special shape windows



#### OPENING: Inside view



**FIXED (direct glazing)**  
Min sizes 330 x 330 mm

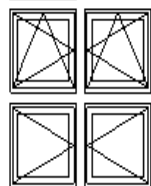

**Tilt and turn (left/right)**  
Min max L= 420...1710 mm H= 420...2527 mm,  
max weight of sash 130 kg

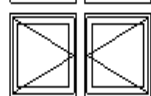

**Turn only (left/right)**  
Min max L= 420...1710 mm H= 420...2527 mm,  
max weight of sash 130 kg



**Tilt only**  
Min max L= 440...2500 mm H= 420...1300 mm,  
max weight of sash 80 kg

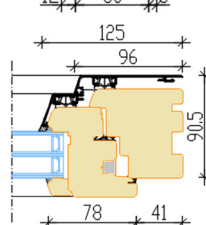
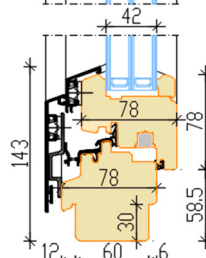
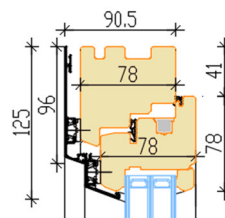

Operable window

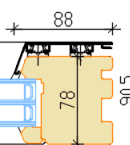
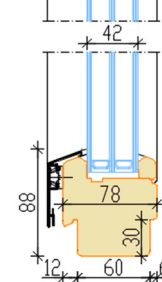
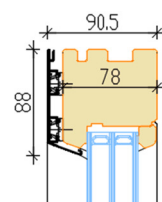

Fixed window

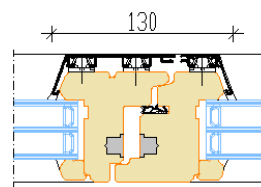

Section without mullion  
Secondary sash/Primary sash

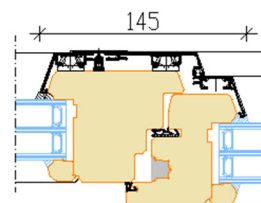

Section through mullion  
Opening sash /Fixed light

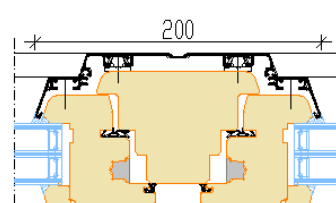

Section through fixed mullion  
Opening sash/Opening sash

#### Handle positions:

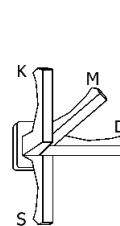

K - Tilt position (ventilation)



M - Microventilation



D - Turn position  
for quick air exchange or  
window washing



S - Closed