

Aru ED 60 Flush-2 EX

outwards opening 2-seal exterior door

- Made to Measure Sizes
- Frame 115x54 mm
- Door leaf thickness 60 mm
- Seals in the frame and around the door leaf
- Frame timber selection:
 - fingerjointed or selected laminated pine timber
 - laminated oak timber
 - laminated meranti timber
- Combi or oak threshold
- Finishing with waterbased paint according to RAL or NCS colour chart
- Double or triple glazing
- Glazing bar options:
 - glued on both sides of the glass+slats inside the glazing (Norwegian style)
 - glued on both sides of the glass (Georgian style)
 - decorative bars inside the glazing
- Ornament:
 - grooves (only on one side or on both sides)
 - glued-on decorative moldings
 - glued-on details
 - glued-on Stainless steel sheet
- 2D adjustable hinges
- Assa modular locks
- Extras:
 - rebated front edge of door leaf
 - grooves for jamb extension
 - jamb extensions
 - special glasses (toughened, laminated, sun protection, pattern)
 - various glass spacers
 - concealed hinges
 - different lock cylinders, serialized cylinders
 - door handles
 - door closer or stopper
 - letter slot, spy-hole, knocker, timber weather bar, kick plate
- Combinations with fixed parts only in separate frames

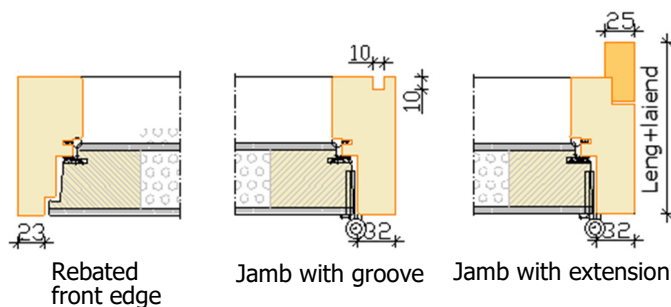
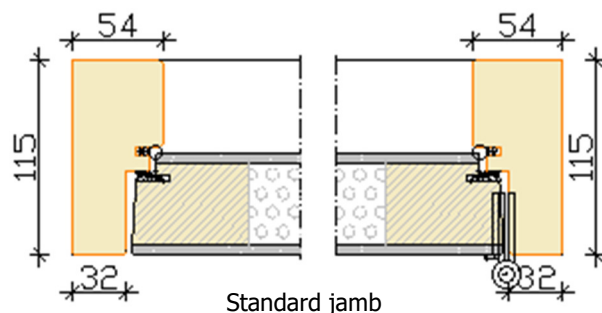
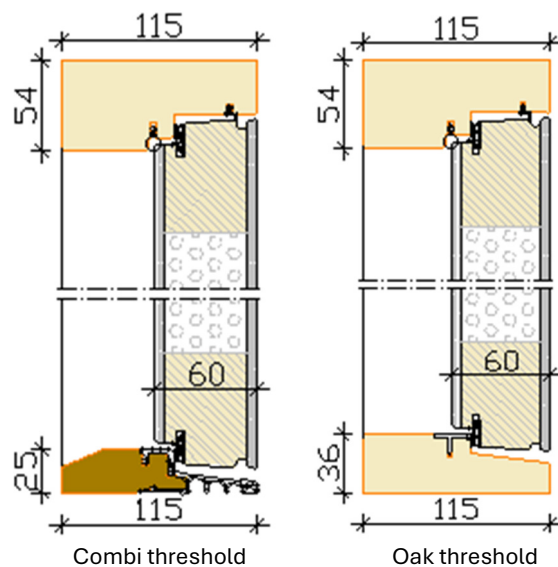
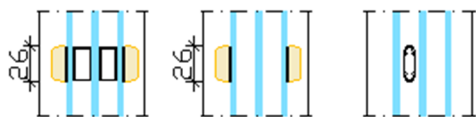

OPENINGS

Views from outside

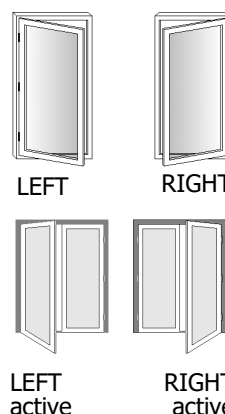

Glass and milled grooves

Stainless steel around the glass

Door with opening side part

More information from our specialists. The manufacturer reserves the right to make changes.